

RECOMMENDED P. C. Board Layout

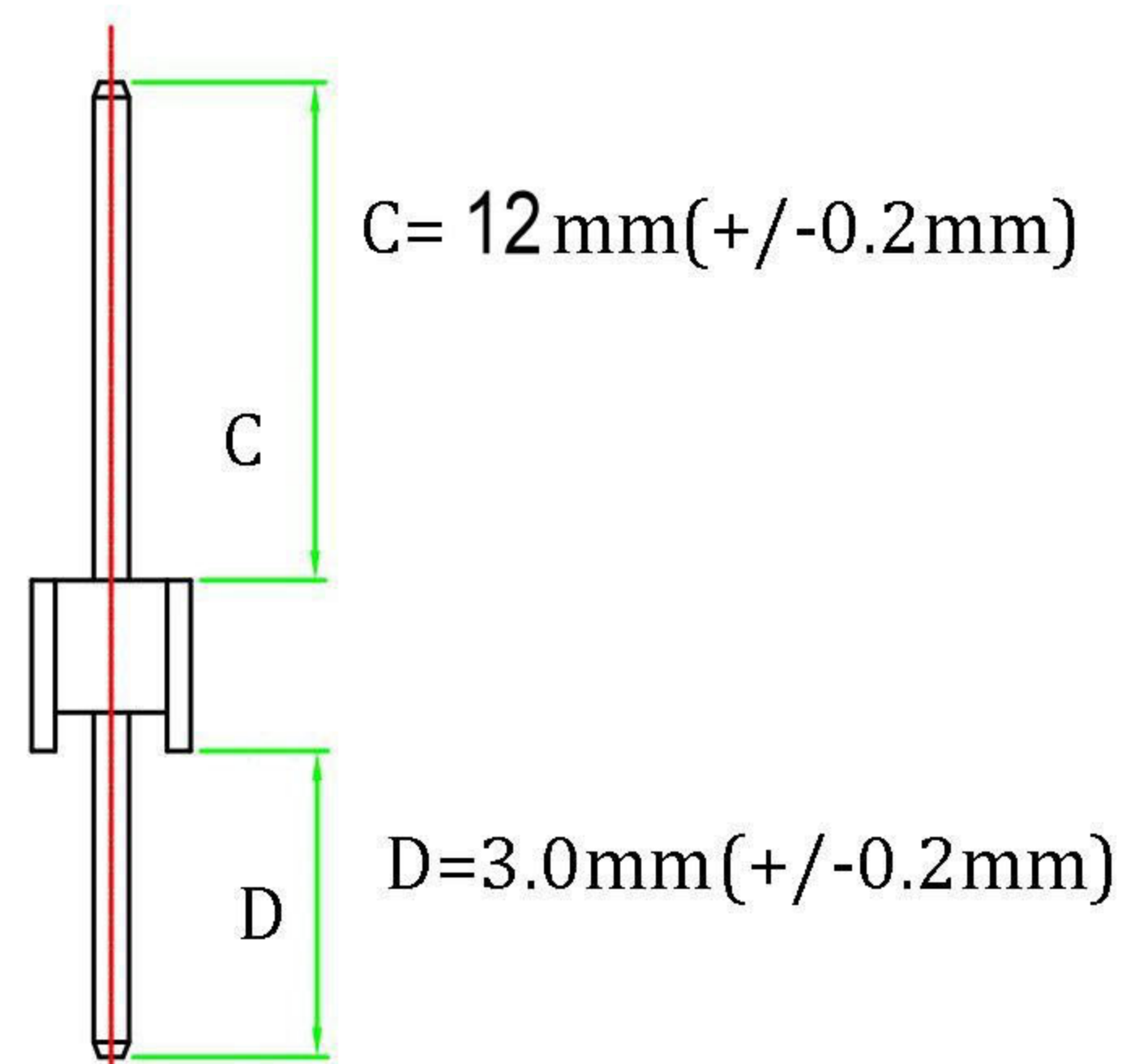
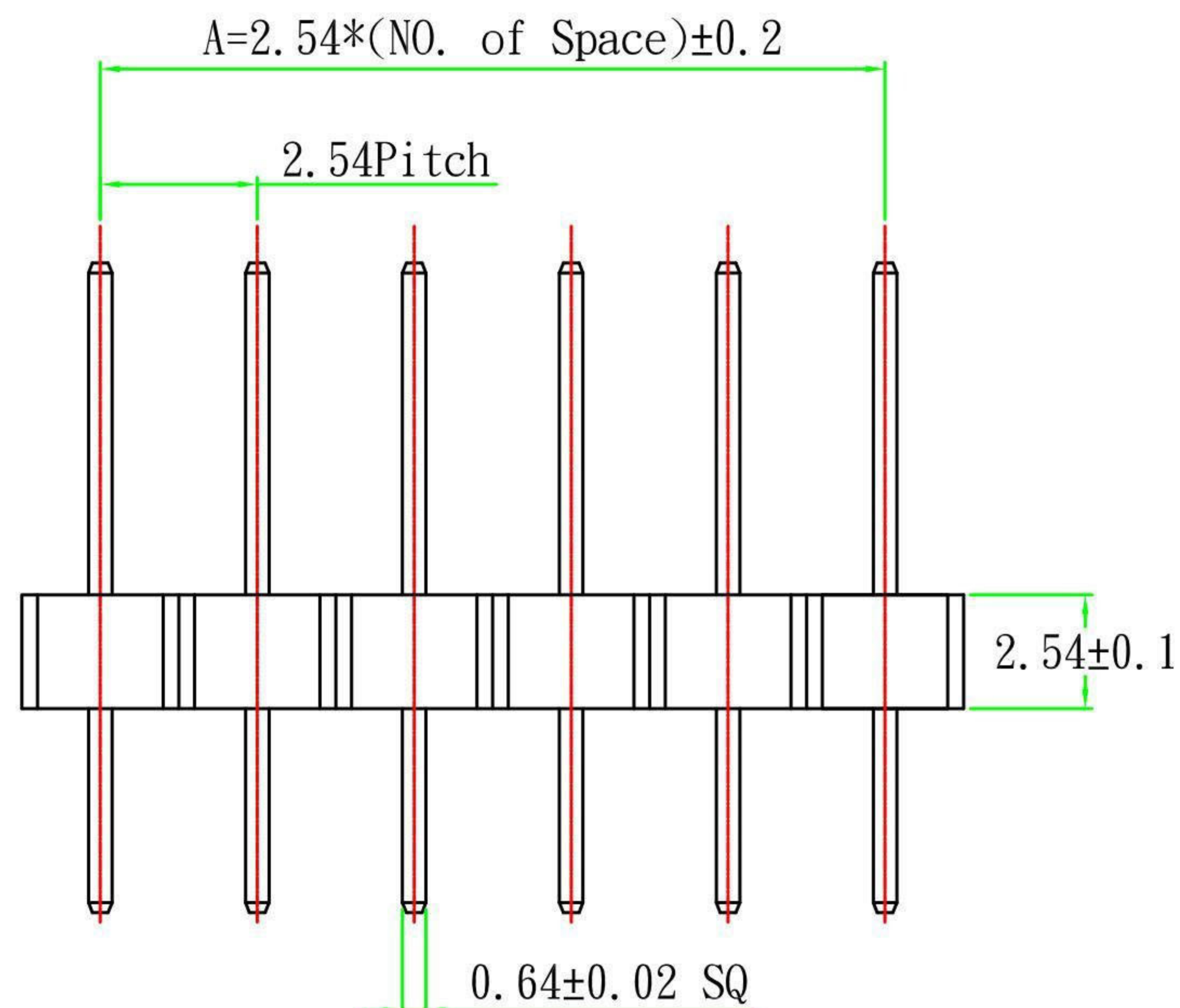

CONTACTS	1*21
1*2	1*22
1*3	1*23
1*4	1*24
1*5	1*25
1*6	1*26
1*7	1*27
1*8	1*28
1*9	1*29
1*10	1*30
1*11	1*31
1*12	1*32
1*13	1*33
1*14	1*34
1*15	1*35
1*16	1*36
1*17	1*37
1*18	1*38
1*19	1*39
1*20	1*40

MATERIAL

HOUSING: PBT

CONTACT: Brass

FINISH: Gold flash Plated over nickel

SPECIFICATIONS

CURRENT: 3A

OPERATING TEMPERATURE: -40°C TO $+105^{\circ}\text{C}$

CONTACT RESISTANCE: 20 MILIOHM MAX.

INSULATION RESISTANCE: 5000 MOHM MIN.

WITHSTANDING VOLTAGE: AC 500V

**RoHS
Compliant**

T&T Connection System Co., Ltd.

APPD. BETTY	 SCALE 参考 UNIT M M PAGE 1 OF 1	TOLERANCE .0 ± .00 ± ANG. ±	PART NAME 品名 PIN HEADER 2.54MM STRAIGHT SINGLE ROW (C=12MM; D=3MM)
DWG. ABBY		SIZE. A 4	PART NO. 料 號 PHSS-xx-12/3
DATE 2014/10/28		REV. A	