

$$A = (\text{NO. OF POSITION PER ROW}) \times 2.54 + 0.50$$

$$B = (\text{NO. OF POSITION PER ROW} - 1) \times 2.54$$

### SPECIFICATIONS

Current Rating: 3 Amp. Max.

Withstanding Voltage: 1000V AC R.M.S. /min

Insulation Resistance: 5000M ohms min. At 1000V DC

Contact Resistance: 30m ohms Max.

Operating Temperature: -55° C to +105° C

### MATERIAL&FINISH

Housing: P. B. T. (UL 94V-0)

Color: Black

Terminal: Copper Alloy

Finish: Gold Plating (t=0.40MM)

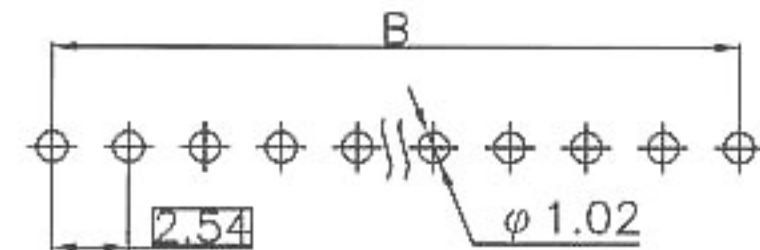
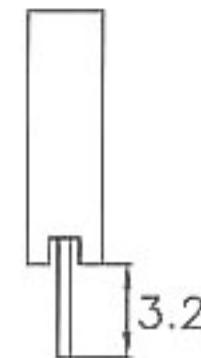
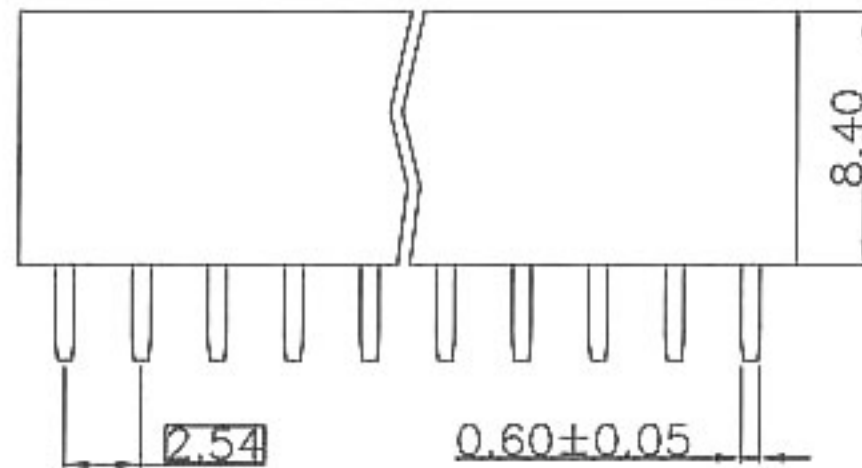
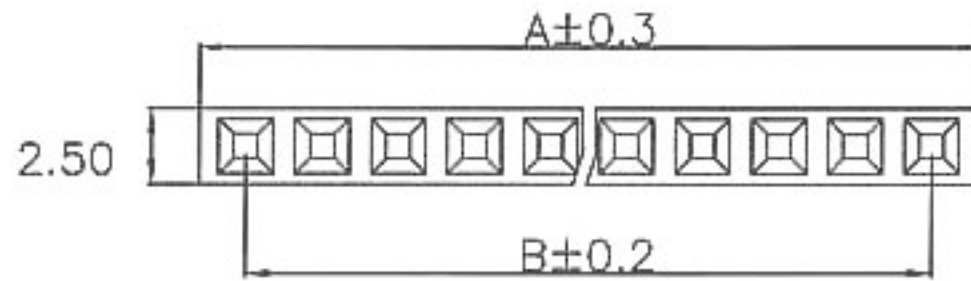

**T&T** Connection System Co., Ltd.

制表日: 2002/12/04

DRAWING.

Jane

APPROVED

UNIT

MM

SCALE

3:1

PART NAME

2.54mm FEMALE HEADER  
180° SINGLE ROW H=8.4mm

APPD.

CKD.

TOLERANCE

$\pm 0.3$

PART NO.

FHSH 2,54 - xx

REV.

A